

# Have your say

# Longford Racecourse

# Preliminary Master Plan

A preliminary Master Plan for the Longford Racecourse precinct has been released for industry and community feedback.

Mayor, Mary Knowles OAM, says the preliminary Master Plan, developed in partnership with Tasracing as the owners, recognises the historical and recreational importance of the Longford racecourse.

“The Master Plan ensures any development of the area will be in keeping with the role and function of the racecourse,” she said.

“Council announced in April it would collaborate with Tasracing to develop a high-level Master Plan and Specific Area Plan to secure the precinct’s future and to ensure that, while giving it protection, the land also remains available for uses such as a vet centre and domestic animal boarding.

The preliminary Master Plan includes improvements to existing infrastructure, such as the amenities, creation of a public park and interpretation facilities as well as increased and improved upgrades to current parking and potentially even increased car parking opportunities,” Mayor Knowles said.

“The master planning process also identifies potential improvements to the precinct, including additional equestrian facilities, horse stalls and a polo field.”

“It will also assist to achieve significant environmental improvements through a whole-of-site approach to environmentally sustainable design, based on three key themes: energy, water, and waste.”

Another of the proposals is for the preparation of an Area Horse Trail Strategy to consider the establishment of a stable and commencement point for a local horse trail.

Tasracing CEO Paul Eriksson says that, like the council, the company is keen to ensure the ongoing viability of the Longford Racing Centre.

“In the masterplan, Tasracing has outlined a proposed infrastructure spend of \$2.6 million, with a further \$1.5 million of additional funds for an equine multi-use facility,” he said.

“Approximately \$700,000 of the proposed infrastructure spend is funded by a Tasmanian Government one-off infrastructure grant,” Mr Eriksson said.

The Longford Races have been held continuously since 1845 and Longford is still home to many horse-training facilities. The track hosts the Longford Cup on New Year’s Day each year, conducts an average of 18 trial meetings a year, and operates as a training facility all year round.

Mr Eriksson said infrastructure options for the Longford track would be included in Tasracing’s \$47m five-year infrastructure plan for the industry.

The Tasmanian racing industry and the community will be consulted on the preliminary Master Plan.

“These projects, which will be discussed directly with industry, are all designed to ensure Longford continues to play a key role in the thoroughbred training landscape in northern Tasmania,” Mr Eriksson said.

Council has written to adjoining property owners seeking comment on the Plan.

The Master Plan will be available for viewing on Council’s website [www.northernmidlands.tas.gov.au](http://www.northernmidlands.tas.gov.au) and feedback is welcome from all members of the community and horse racing fraternity, with public comment closing on 21 December 2021.

Please address your feedback to Council’s General Manager by email to [council@nmc.tas.gov.au](mailto:council@nmc.tas.gov.au) or in writing to PO Box 156, Longford Tas 7301, or drop your written comments to the Council Offices at 13 Smith Street Longford.

## KEY

- |  |   |
|--|---|
| <b>A</b> Existing earthwork scrapings to be smoothed over.   | <b>11</b> Race day media commentator’s tower.   |
| <b>B</b> Existing equine pool to be removed and filled in.   | <b>12</b> Race horse parade area and race track access.   |
| <b>C</b> Existing sand loop to be removed.   | <b>13</b> Primary vehicle entry point.  |
| <b>D</b> Existing maintenance storage area to be removed.  | <b>14</b> Members pavilion and amenities.   |
| <b>E</b> Brickendon Street pavement to be removed.   | <b>15</b> Winning post.   |
| <b>F</b> Existing on-site trainer facilities to be demolished.   | <b>16</b> Site maintenance shed.  |
| <b>1</b> Existing portion of site to be dedicated to a public park with interpretation signage about the history of the Longford Racecourse. | <b>17</b> Facilities for visiting trainers.   |
| <b>2</b> Existing chain link fence to be realigned.  | <b>18</b> Stables for visiting trainers and race events.  |
| <b>3</b> Existing turf racetrack.  | <b>19</b> Race event parade ring.   |
| <b>4</b> Existing sand track.  | <b>20</b> Existing access point for visiting trainers.  |
| <b>5</b> Existing racehorse warm up/cool down track.   | <b>21</b> Vehicle manoeuvring area for visiting trainers.   |
| <b>6</b> Existing vehicle access point for events only.  | <b>22</b> Horse loading bays for visiting trainers.   |
| <b>7</b> Off-site trainer access track.  | <b>23</b> Brickendon Street termination head to provide a safer work place for trainers, riders and the public. |
| <b>8</b> Grassed spectator area.   | <b>24</b> Public horse trail leading west to Bishopsbourne.   |
| <b>9</b> Macrocarpa Tree avenue.   | <b>25</b> Realigned security fence.   |
| <b>10</b> Grassed bank spectator area.   | <b>26</b> Public horse trail leading south to Cressy.   |
|  | <b>27</b> Site maintenance fenced compound.   |
|  | <b>28</b> Existing race commentator’s tower.  |

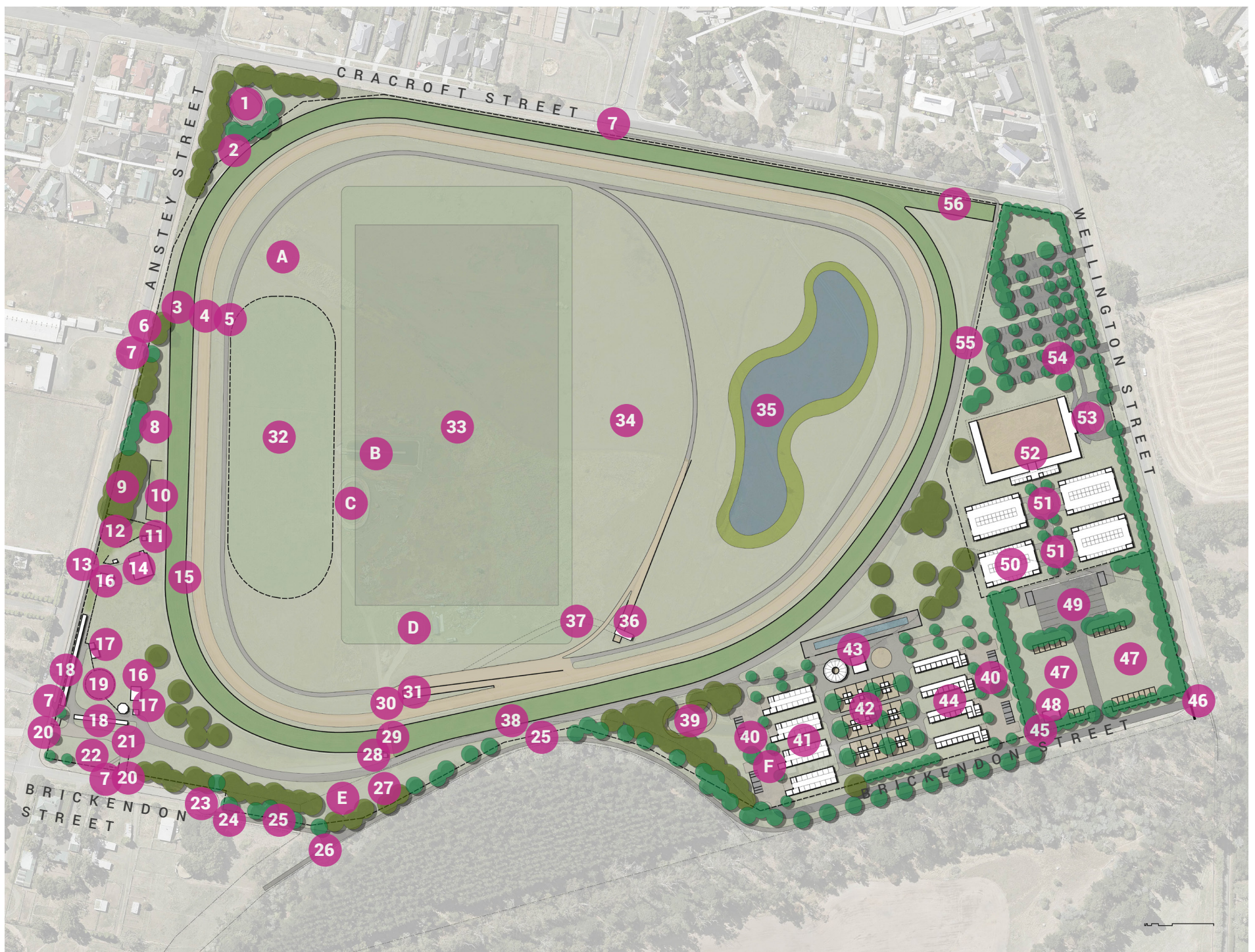

- 29** Access across the race track.
- 30** Internal activity junction area.
- 31** Training gates with sand breakaway track.
- 32** Fenced racehorse warm up paddock.
- 33** International size Polo field and run-out zone. The field can also be used for local pony clubs and other equestrian related activities that do not interfere with current training and racing activities.
- 34** Designated area for car/truck/float parking, event marquees and other temporary structures associated with the Polo field and other activities.
- 35** Large wetland / irrigation storage dam with a surrounding low growing native vegetation buffer.
- 36** Starting gates and sand breakaway track.
- 37** Approximate zone required for manoeuvring the starting gates to and from the starting chute.
- 38** Realigned horse and maintenance vehicle track.
- 39** 100m long fenced sand ring.
- 40** Sawdust, manure and general storage bays for adjoining on-site trainer barns. Large vehicle parking bays are also provided within this area.
- 41** Four 12 x 32m Barns with fourteen individual 4 x 4m training boxes, office, tack room, feed room, laundry and toilet.
- 42** Thirty individual 8 x 8m day yards with shelter.
- 43** On-site training facilities including 5 x 70m fenced equine pool, equine treadmill shed, covered seating / lunch area, covered sand ring and an open sand ring.
- 44** Four 8 x 32m Barns with seven individual 4 x 4m training boxes, office, tack room, feed room, laundry and toilet.
- 45** Public horse trail access point associated with the designated gathering area.
- 46** Gated entry point for racecourse users only.
- 47** Public equestrian club gathering area including 24 individual 4 x 6m day yards, and large open space for manoeuvring and parking. Unloading/loading ramps located closer to the larger barns (49).
- 48** Public equestrian clubhouse.
- 49** Sealed area for vehicle manoeuvring and large vehicle/truck parking associated with the four barns and the indoor equestrian arena. Two 50m<sup>2</sup> horse unloading/loading ramps are also provided for public use, the barns and arena.
- 50** Four 25 x 40m Barns with forty individual 3 x 3m boxes, vet room, office, tack room, feed room, wash down bay, laundry and amenities.
- 51** Two 15m (dia.) pre-parade sand rings.
- 52** Multi-use indoor equestrian centre with a 50 x 70m sand riding arena for multiple equestrian activities and events. The centre will also include eight livestock boxes, equipment storage rooms, large conference/function room, commercial kitchen, amenities, office, meeting rooms, private viewing boxes and tiered spectator seating. The northern face of the arena will be open to the elements.
- 53** Equestrian centre porte cochere and reception area with a one-way looped driveway for visitor drop off/pick ups and deliveries.
- 54** 124 Bay sealed car park with two entry/exit access points off Wellington Street and one access point from the porte cochere for valet parking services. Grassed area to the north of the car park provides additional space for overflow parking as required.
- 55** Track access to race day starting gates and chute.
- 56** Race track chute to create an 800m starting run.



NORTHERN  
MIDLANDS  
COUNCIL

**LANGE**  
design  
landscape architecture

## Contact Us

PO Box 156, Longford, TAS 7301 | Tel: (03) 6397 7303 | council@nmc.tas.gov.au | www.northernmidlands.tas.gov.au | @northernmidlandscouncil