

This planning application is open for
public comment until
06 October 2025

Reference no	PLN-25-0178
Site	1 PORTUGAL STREET ROSS
Proposed Development	Change of Use - Cottage to Visitor Accommodation (Parking and Sustainable Transport Code)
Zone	8.0 General Residential
Use class	Residential

Written representations may be made during this time to the General Manager;
mailed to PO Box 156, Longford, Tasmania 7301,
delivered to Council offices or
a pdf letter emailed to planning@nmc.tas.gov.au

(no special form required)



NORTHERN
MIDLANDS
COUNCIL

PLANNING APPLICATION

FOR BUILDINGS, WORKS AND CHANGE OF USE

(E.g. Residential houses, sheds, carports, retaining walls, visitor accommodation, commercial development, signage etc.)

Office Use Only:

The Proposal

Description of proposal:

COTTAGE SHORT TERM RENTAL B+B. APPLICATION

Driveway construction material:

GRAVEL + GRASS.

The Land

Site address:

1 PORTUGAL ST ROSS 7209

Title reference:

C/T:

Existing buildings on site:

MAIN HOUSE + COTTAGE + SHED

Existing use of site:

PRIMARY RESIDENCE

Applicant justification of any variation/discretion to the
Tasmanian Planning Scheme – Northern Midlands

ORIGINAL - NOT TO BE REMOVED FROM TITLES OFFICE

R.P. 1469

TASMANIA

REAL PROPERTY ACT, 1862, as amended

NOTE—REGISTERED FOR OFFICE

CONVENIENCE TO REPLACE



CERTIFICATE OF TITLE

Register Book

Vol. Fol.

3103 53

Cert. of Title Vol. 285 Fol. 198

I certify that the person described in the First Schedule is the registered proprietor of an estate in fee simple in the land within described together with such interests and subject to such encumbrances and interests as are shown in the Second Schedule. In witness whereof I have hereunto signed my name and affixed my seal.

[Signature]

Recorder of Titles.



DESCRIPTION OF LAND

TOWN OF ROSS

TWO ROODS THIRTY SEVEN PERCHES AND FIVE TENTHS OF A PERCH
on the Plan hereon

FIRST SCHEDULE (continued overleaf)

JOHN JOSEPH HARVEY of Ross.

SECOND SCHEDULE (continued overleaf)

NIL.

Lot 1 of this plan consists of all the
land comprised in the above-mentioned
cancelled folio of the Register.

REGISTERED NUMBER

230903

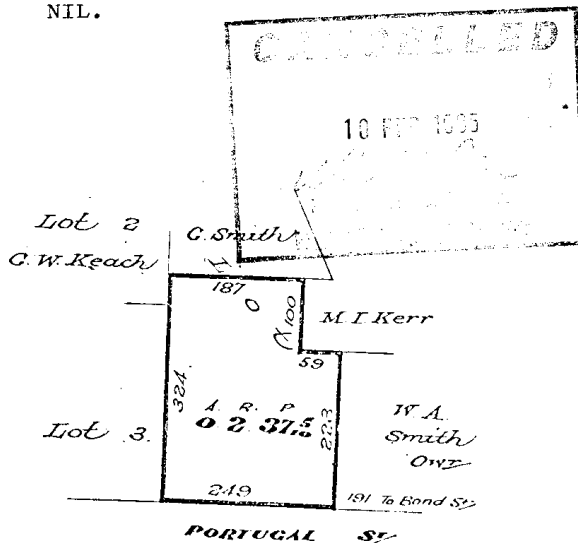

Part of Lot 1. Sec. X. - Gtd. to W. Smith - Meas. in Links.

FIRST Edition. Registered

Derived from C.T. Vol. 285, Fol. 198. Transfer 53929 E.E. Smith.

Exhibited

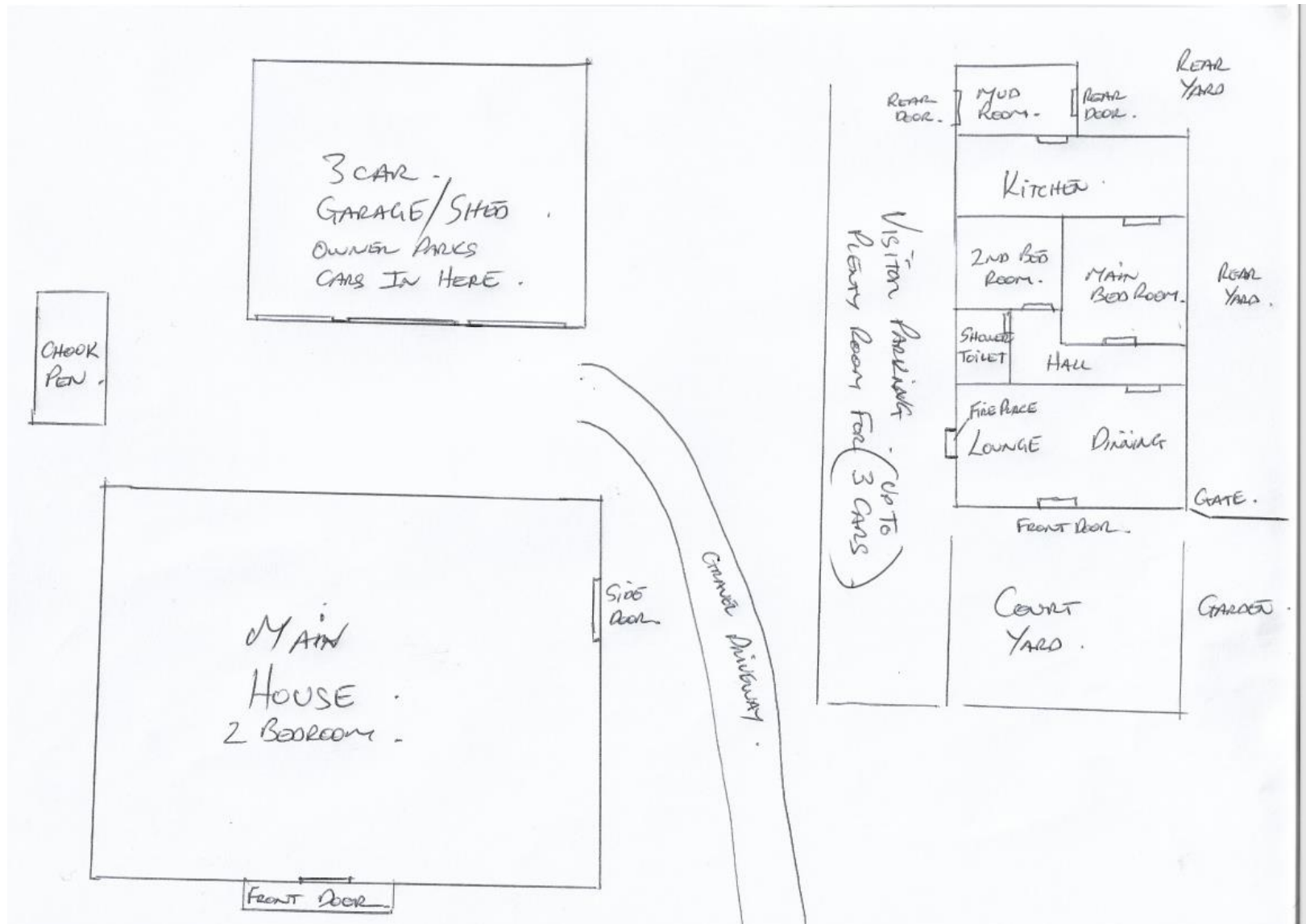

Exhibited

